

3/7795-11(6885324); NORMAL(1:500)

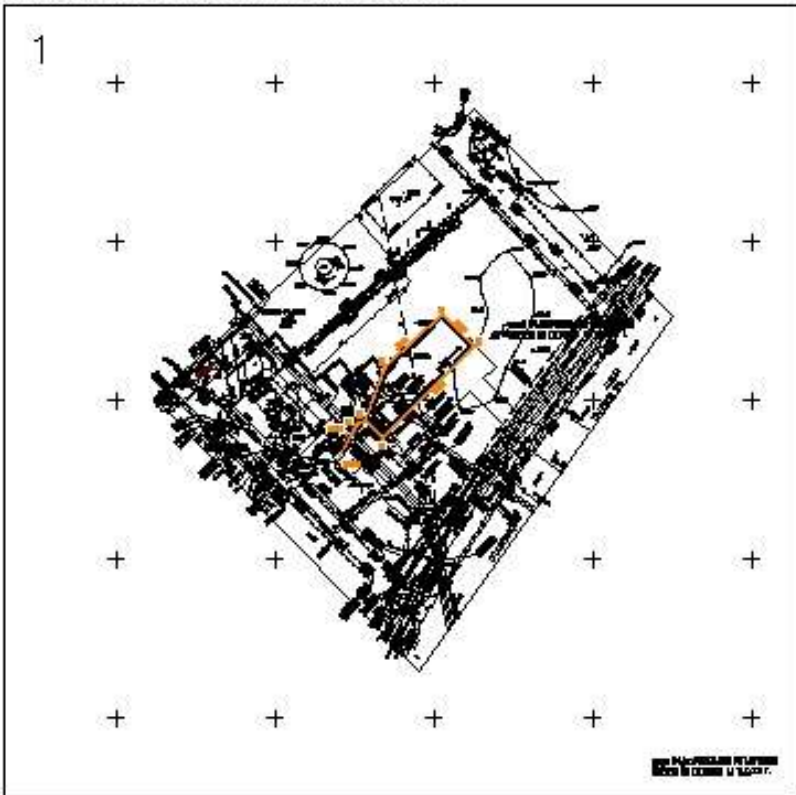

SECRET

GENERAL INFORMATION

1. This drawing is a perspective view of the hull structure of the ship shown in the pictorial reference. It is a normal view of the hull structure at a scale of 1:500. The hull structure is shown in a diamond shape, with the bow at the top and the stern at the bottom. The hull structure is composed of numerous internal components, including the main engine, auxiliary engines, and various support structures. The hull structure is shown in a perspective view, with the bow at the top and the stern at the bottom. The hull structure is shown in a diamond shape, with the bow at the top and the stern at the bottom. The hull structure is composed of numerous internal components, including the main engine, auxiliary engines, and various support structures.

2. The hull structure is shown in a perspective view, with the bow at the top and the stern at the bottom. The hull structure is shown in a diamond shape, with the bow at the top and the stern at the bottom. The hull structure is composed of numerous internal components, including the main engine, auxiliary engines, and various support structures. The hull structure is shown in a perspective view, with the bow at the top and the stern at the bottom. The hull structure is shown in a diamond shape, with the bow at the top and the stern at the bottom. The hull structure is composed of numerous internal components, including the main engine, auxiliary engines, and various support structures.

SECRET

SECRET

SECRET

NO.	DESCRIPTION	REF.
1	MAIN ENGINE	1
2	AUXILIARY ENGINES	2
3	SUPPORT STRUCTURES	3

NO.	DESCRIPTION	REF.
1	MAIN ENGINE	1
2	AUXILIARY ENGINES	2
3	SUPPORT STRUCTURES	3